

# SAINT LOUIS GALLERIA

1155 ST. LOUIS GALLERIA ST | RICHMOND HEIGHTS, MO

**Brookfield**  
Properties



4 FORMER RESTAURANT SPACES AND 2 RETAIL SPACES IN GREAT CONDITION  
AVAILABLE FOR LEASE IN ONE OF ST. LOUIS' TOP PERFORMING MALLS.

# ST. LOUIS GALLERIA

## ABOUT THE PROPERTY



THE SAINT LOUIS GALLERIA, ONE OF ST. LOUIS' TOP-PERFORMING MALLS, HAS SEVERAL EXCEPTIONAL LEASING OPPORTUNITIES WITH THREE FORMER RESTAURANT SPACES AND TWO RETAIL SPACES AVAILABLE, ALL IN GREAT CONDITION.

HOME TO MORE THAN 165 OF THE HOTTEST RETAIL BRANDS AND RESTAURANTS IN THE COUNTRY, INCLUDING OVER 25 EXCLUSIVE TO THE MARKET, THE GALLERIA IS A PRIME LOCATION FOR BUSINESSES LOOKING TO JOIN AN ESTEEMED GROUP OF RETAILERS. ANCHORED BY MAJOR DEPARTMENT STORES LIKE DILLARD'S, MACY'S, AND NORDSTROM, AND FEATURING TOP RETAILERS SUCH AS APPLE, H&M, AND VICTORIA'S SECRET, THE MALL ATTRACTS A DIVERSE AND ENGAGED AUDIENCE.

LOCATED JUST ONE MILE FROM THE PRESTIGIOUS CLAYTON CENTRAL BUSINESS DISTRICT, THE SAINT LOUIS GALLERIA OFFERS THE PERFECT SETTING TO SHOWCASE YOUR BRAND AND CONNECT WITH SHOPPERS FROM ACROSS THE REGION. TO DISCUSS THESE OPPORTUNITIES FURTHER AND POSITION YOUR BUSINESS IN ONE OF ST. LOUIS' MOST VIBRANT RETAIL ENVIRONMENTS, PLEASE REACH OUT TO OUR BROKERAGE TEAM.



Google Maps



# ST. LOUIS GALLERIA NEIGHBORHOOD VIBE



1 mile      3 miles      5 miles

**POPULATION**      14,029      109,772      287,726

**HOUSEHOLDS**      7,075      49,690      133,202

**EMPLOYEES**      18,798      102,759      205,058

**MED HH INCOME**      \$133,575      \$111,531      \$93,815

Brentwood is a thriving community located in the heart of St. Louis County, just south of the county seat, Clayton, and a mile and a half west of the city of St. Louis. Brentwood is known as the "City of Warmth" because of its small town charm and sense of community. Brentwood encompasses a mere 1.5 square miles yet is packed full of advantages as a business and employment center. As part of the mid-county employment hub, the city's daytime population is nearly triple the residential population. Brentwood's central location, as well as its proximity to major research hospitals, universities and downtown St. Louis are reasons many technology and life-science businesses are located there.

Located at the intersection of I-64 and I-170 in the heart of the St. Louis metro area, Richmond Heights successfully melds "Progress with Tradition." Richmond Heights boasts a diverse population from all walks of life; a wide array of well-maintained and attractive homes in established, desirable neighborhoods; quality public and private schools and high-quality city services. Richmond Heights is home to the Saint Louis Galleria, a premier destination shopping mall located in the heart of the city, and St. Louis' #1 performing mall. The Saint Louis Galleria opened in 1984 and is anchored by Macy's, Dillard's and Nordstrom. Also located in Richmond Heights, across from the Saint Louis Galleria is The Boulevard, a premier lifestyle development in the St. Louis metro area. The Boulevard is a vibrant village with a unique blend of upscale retail, fine dining and luxury residences. The Heights' is a 73,000 square foot community center in Richmond Heights. It is one of the largest and well-equipped municipal facilities in the St. Louis metro area with a fully-functioning youth fitness facility, double gymnasium, indoor water park, full-service library and other amenities. SSM St. Mary's, also located in Richmond Heights, is the headquarters for St. Louis University School of Medicine's Department of Obstetrics and Gynecology and its Family Residency programs.

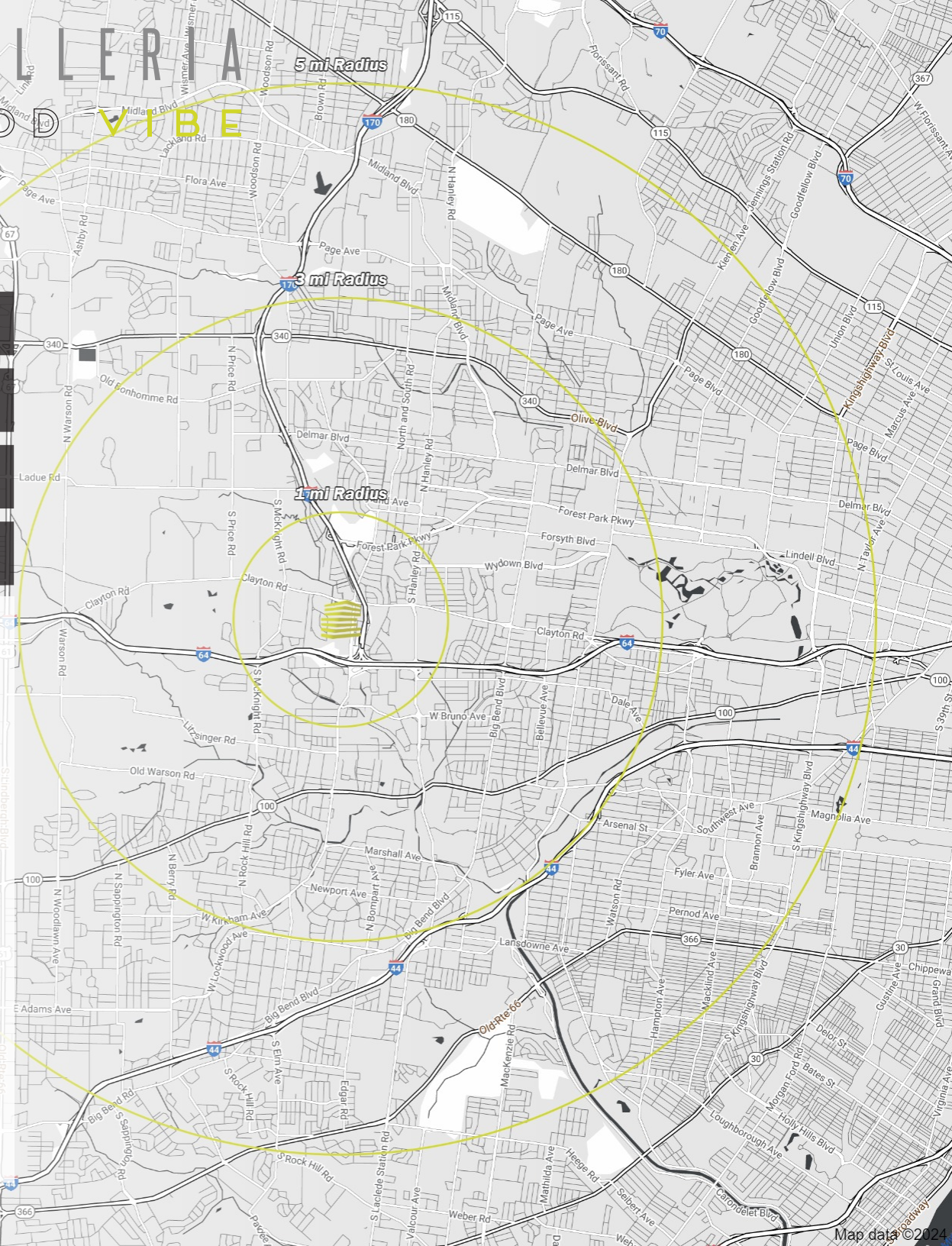

# ST. LOUIS GALLERIA IN GOOD COMPANY



NORDSTROM

★macy's

Dillard's



Panera  
BREAD®

SEPHORA

The  
Cheesecake  
Factory

VICTORIA'S  
SECRET

URBAN OUTFITTERS



H&M

Bath  
& Body  
Works®

Buckle B

EVEREVE

free people

JOHN HENRY'S

LACOSTE

LUSH  
FRESH HANDMADE COSMETICS



WHITE  
HOUSE | BLACK  
MARKET

VANS

TORRID  
FASHION FOR SIZES 10 TO 30

Tommy Bahama®

MICHAEL KORS

# ST. LOUIS GALLERIA

## S I T E P L A N

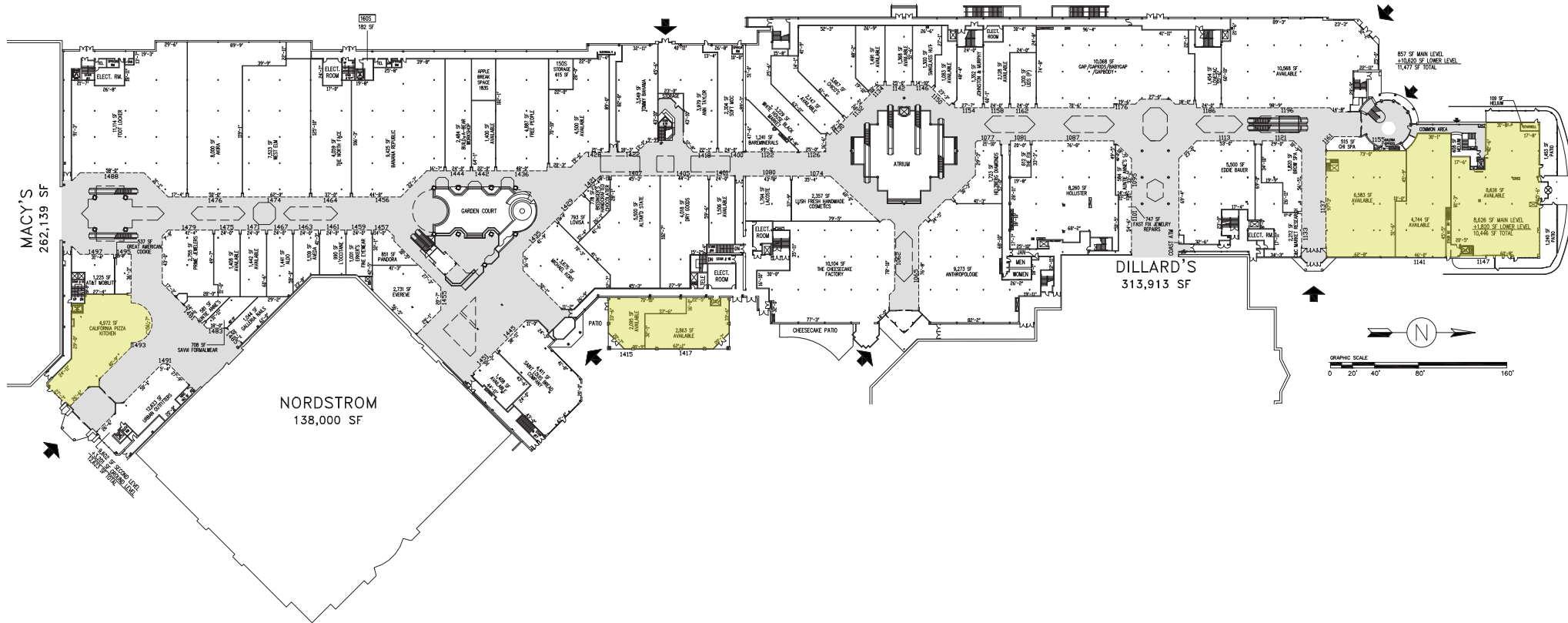

**CLICK TO VIEW**  
UNIT 1493 - 4,927 SF



**CLICK TO VIEW**  
UNIT 1415 - 2,201 SF



**CLICK TO VIEW**  
UNIT 1417 - 2,907 SF



**CLICK TO VIEW**  
UNIT 1137 - 6,583 SF



**CLICK TO VIEW**  
UNIT 1141 - 4,799 SF



**CLICK TO VIEW**  
UNIT 1147 - 8,626 SF

# ST. LOUIS GALLERIA

## AVAILABILITY PHOTOS

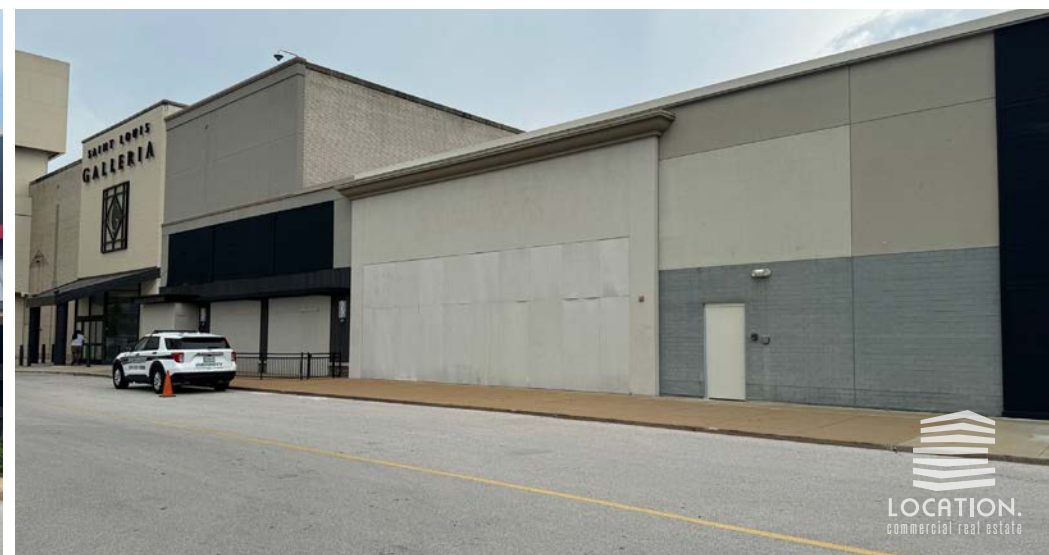

# ST. LOUIS GALLERIA

Z O O M A E R I A L



LOCATION.  
commercial real estate



# ST. LOUIS GALLERIA

## MARKET AERIAL

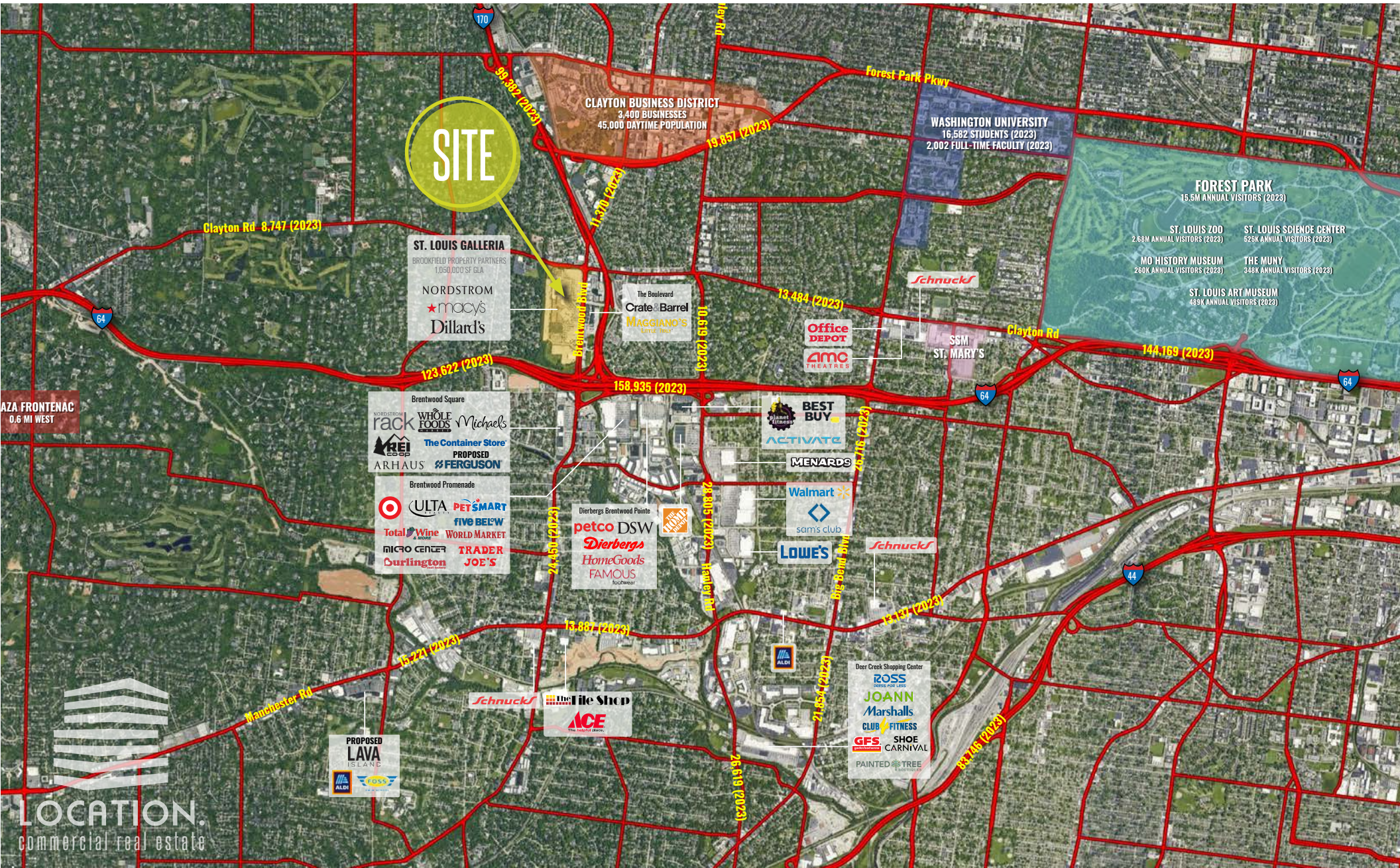





x

**Brookfield  
Properties**

BILL SIEMS	314.363.8327 (mobile)	Bill@LocationCRE.com
ALEX CHIODINI	314.662.0112 (mobile)	AlexC@LocationCRE.com

    [www.LocationCRE.com](http://www.LocationCRE.com)

THE INFORMATION IN THIS FLYER HAS BEEN OBTAINED FROM SOURCES BELIEVED RELIABLE. WHILE WE DO NOT DOUBT ITS ACCURACY, WE HAVE NOT VERIFIED IT AND MAKE NO GUARANTEE ABOUT IT. IT IS YOUR RESPONSIBILITY TO INDEPENDENTLY CONFIRM ITS ACCURACY AND COMPLETENESS. ANY PROJECTIONS, OPINIONS, ASSUMPTIONS OR ESTIMATES USED ARE FOR EXAMPLE ONLY AND DO NOT REPRESENT THE CURRENT OR FUTURE PERFORMANCE OF THE PROPERTY. THE VALUE OF THIS TRANSACTION TO YOU DEPENDS ON TAX AND OTHER FACTORS WHICH SHOULD BE EVALUATED BY YOUR TAX, FINANCIAL AND LEGAL ADVISORS. YOU AND YOUR ADVISORS SHOULD CONDUCT A CAREFUL, INDEPENDENT INVESTIGATION OF THE PROPERTY TO DETERMINE TO YOUR SATISFACTION THE SUITABILITY OF THE PROPERTY FOR YOUR NEEDS.